



INSTALLATION INSTRUCTIONS FOR 70000-02505 AND 70000-02506 MULCHING KITS



SAFETY ALERT SYMBOL

This is the industry's "Safety Alert Symbol." This symbol is used to call your attention to items or operations that could be dangerous to you or other persons using this equipment. Please read these messages and follow these instructions carefully. It is essential that you read the instructions and safety regulations before you attempt to assemble or use this unit.

NOTE: Mulching blades sold separately. Contact your Kubota dealer.

For some RCK60 mower decks, the Left Baffle kit (P/N 70000-02507) may be required to complete mulching kit installation. Contact your Kubota dealer for more information.

TRACTOR/MOWER PREPARATION

1. Park tractor on level surface.
2. Set parking brake.
3. Stop engine and remove key.
4. Discharge deflector must remain installed at all times.

MULCHING KIT INSTALLATION

1. Remove mower deck and turn over so blades are exposed (facing up). Carefully remove all debris from underside of deck.

NOTE: To remove mower deck, consult your owners' manual.

2. Remove all mower blades and save mounting hardware. This hardware will be used again. To prohibit blades from turning while loosening bolts, it will be necessary to wedge a block of wood between the blade and mower housing. (See Figure 1.)
3. Join the right and left baffle plates together. Do not tighten the bolt. Place the baffle plates in the mower deck. Clamp in place insuring that they are parallel with the deck. (See Figure 2.)
4. Using the baffles as templates, center punch each mounting hole.

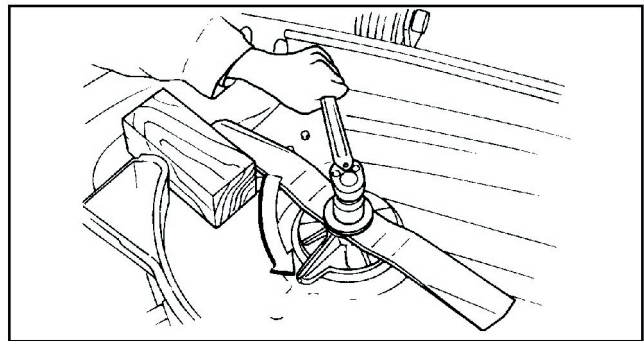

Figure 1

286307700_Fig1

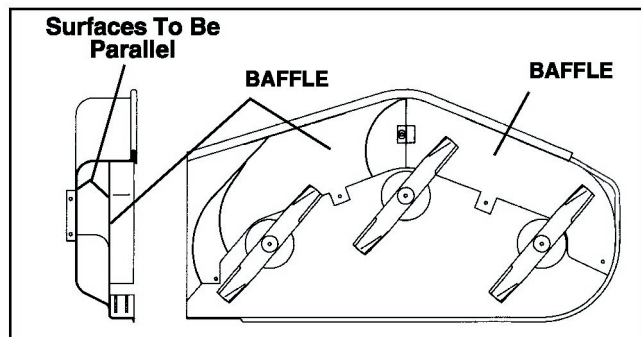

Figure 2

286307700_Fig2

MULCHING KIT INSTALLATION (continued)

5. Remove the baffles and using an 11/32 (.344) diameter drill bit, drill each mounting hole. Deburr each hole.



CAUTION: Prior to drilling mounting holes, insure there are no obstacles on the top side of the deck for the drill to interfere with.

6. Using mounting hardware provided, install left and right baffle plates. Bolts should be installed from the bottom side of the deck. Nuts should be installed on the top side of the deck. Install bolts loosely until all bolts are in place. Then tighten all hardware.
7. Using the blade mounting hardware removed in Step 2, install the new mulching blades ordered separately, referring to Figure 3 or Figure 4 depending on the mower deck model. Torque the blade bolt as recommended in the operators' manual for the tractor.

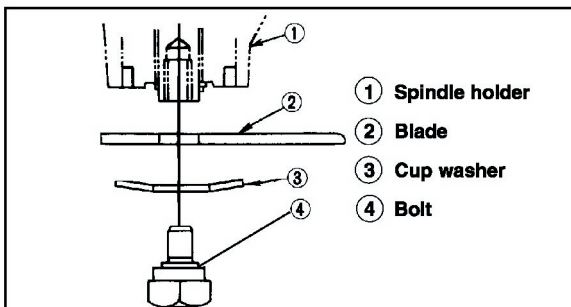

Figure 3

286307700_Fig4

8. Rotate the blades by hand to check for interference prior reinstalling the mower deck. If the blades make any contact with the baffles, make the necessary adjustments to eliminate the interference.
9. Reinstall mower deck.

NOTE: To install mower deck, consult your owners' manual.

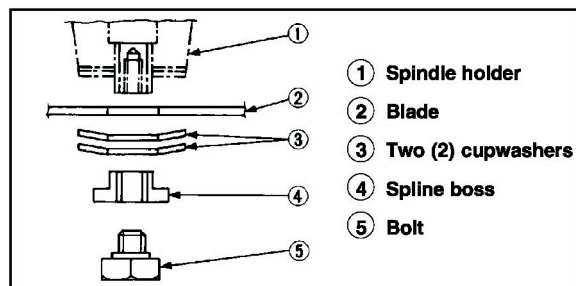

Figure 4

286307700_Fig5

10. Torque all bolts according to specifications.
11. If mulching baffles are removed, reinstall mounting hardware and tighten securely.



WARNING: Mulching blades should be turned by hand to insure clearance between blades and newly installed baffles. Failure to do so could result in damage to equipment and/or injury to persons. If clearance does not exist, contact your Kubota dealer.

PARTS LIST 70000-02505 60" KIT

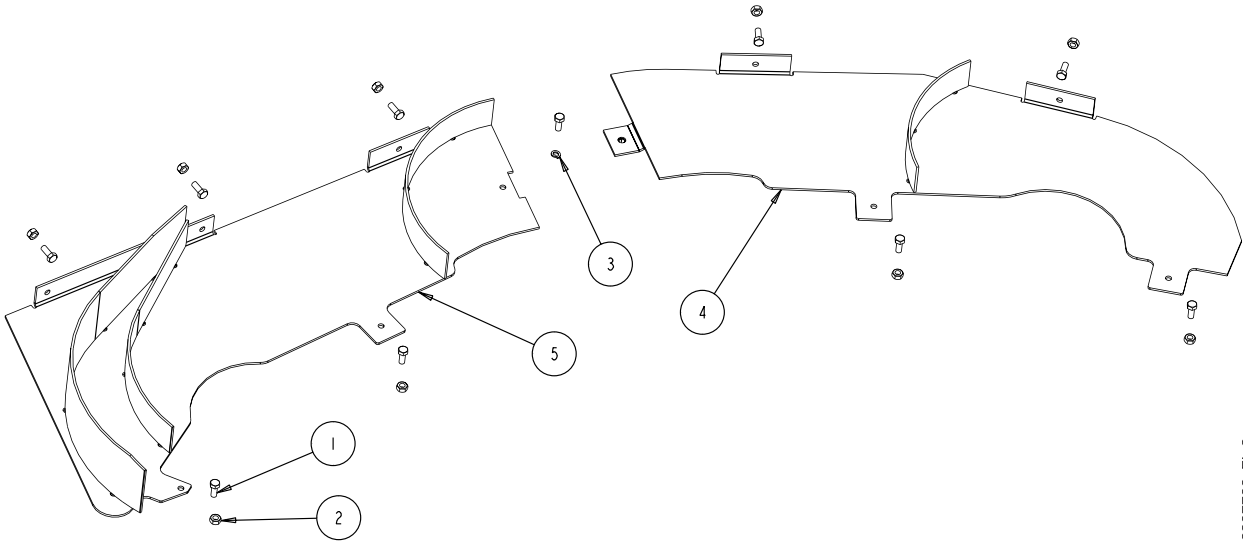

286307700_Fig6

Item No.	Part No.	Description	Qty
1	01053-50820	BOLT M8 - 1.25 x 20mm	10
2	02054-50080	LOCK NUT M8 - 1.25	9
3	04513-50080	LOCK WASHER 8mm	1
4	N/A	BAFFLE LH 60"	1
5	N/A	BAFFLE RH 60"	1

286307700_Fig8

PARTS LIST 70000-02506 72" KIT

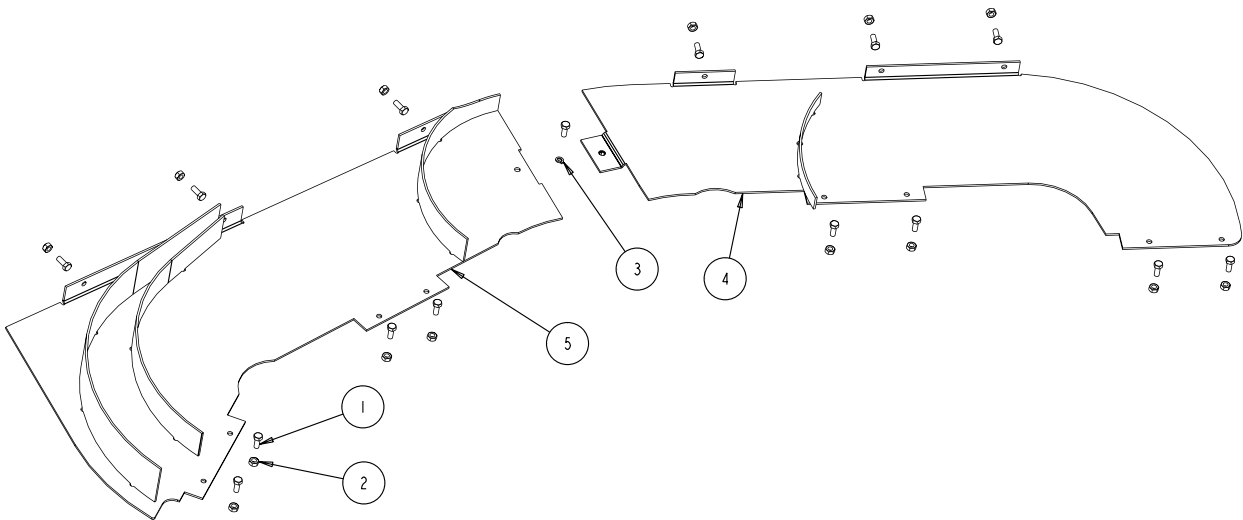

286307700_Fig7

Item No.	Part No.	Description	Qty
1	01053-50820	BOLT M8 - 1.25 x 20mm	15
2	02054-50080	LOCK NUT M8 - 1.25	14
3	04513-50080	LOCK WASHER 8mm	1
4	N/A	BAFFLE LH 72"	1
5	N/A	BAFFLE RH 72"	1

286307700_Fig9